

# Kronner

## Low Profile Scope Holder

for holding laparoscopes and other endoscopes

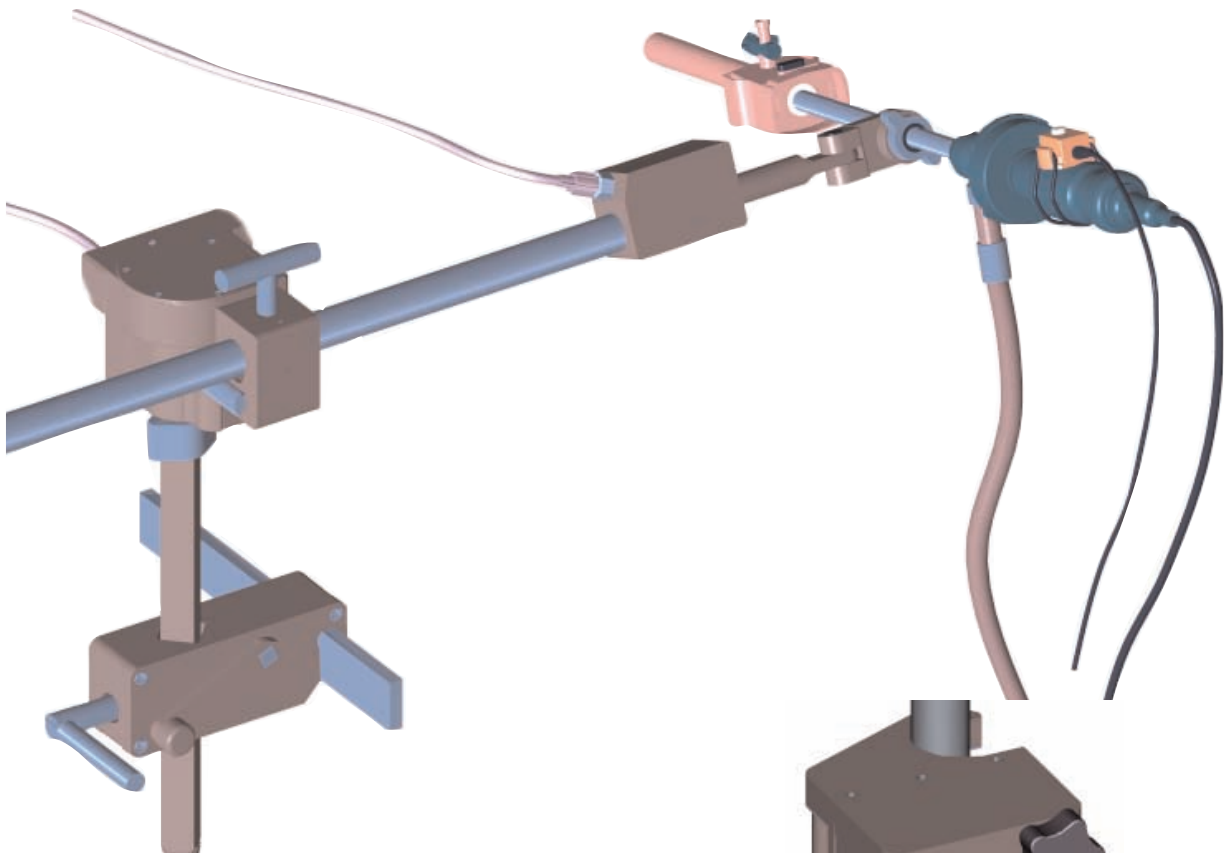

**Steady view**  
**Rapid set-up**  
**Surgeon controls scope**  
**Rapid position changes**  
**Scope movement unrestricted**  
**Does not interfere with instruments**  
**Less staff required**



U.S. Patent No. 5,957,423

Kronner Medical Mfg., 1443 Upper Cleveland Rapids Road, Roseburg, OR 97471

Phone: 800-706-3533 / 541-672-2543

Fax: 541-672-1074

E-mail: [kronner@kronner.com](mailto:kronner@kronner.com) Website: <http://www.kronner.com>

# The Kronner Scope Holder

The **Kronner Low Profile Scope Holder** is used to hold endoscopes such as laparoscopes during endoscopic surgery. It **firmly holds the position of the scope** and **frees the operators' hands** for other tasks. It **can be moved with one hand** to allow the scope to view the entire abdominal cavity without restriction from the Holder.

The **Holder attaches to the side rail** of the operating table. It may be located on either side of the table and away from the operating area.

The low profile **telescoping arm holds the endoscope** and does not interfere with instruments inserted through other cannulae, portable x-ray equipment or c-arms. In the rare event it does interfere, it can quickly be disconnected from the scope and positioned out of the way.

The **control is attached to the camera by a rubber band** where it is readily accessible. It is connected by a flexible line to the control box. **Pressing a button on the control**, with the hand used to move the scope, **releases Holder joints** for quick position changes. When the button is released, the position is held by gas pressure from nitrogen gas available in the operating room or from a portable tank.

The **control box regulates the gas** from the hospital source and supplies it to the Holder through two disposable lines. The box **has safety features** in the event problems arise.

The Holder can be **easily set up by operating room staff** prior to the procedure. During set up, the telescoping arm can be set to accommodate the range required for the procedure. When needed, the scope can be quickly attached.

The versatile Holder can be **used for laparoscopy, thoroscopy, arthroscopic surgery\*, nasal surgery\* and holding other manual surgical instruments\***.

**If a failure occurs, the scope remains held in position**, (lock-up). If the problem cannot be corrected, the scope can be released and the arm detached so the procedure can be finished.

**Only some components must be sterilized** and they can be steam autoclaved. The two **gas lines are supplied sterile** and are disposable. A rubber loop to hold the control to the camera is supplied sterile with each gas line set.

All components that require cleaning can be **easily disassembled and reassembled**.

Components are made of **durable** materials. Reusable components will provide many years of service.

\* May require additional accessories.

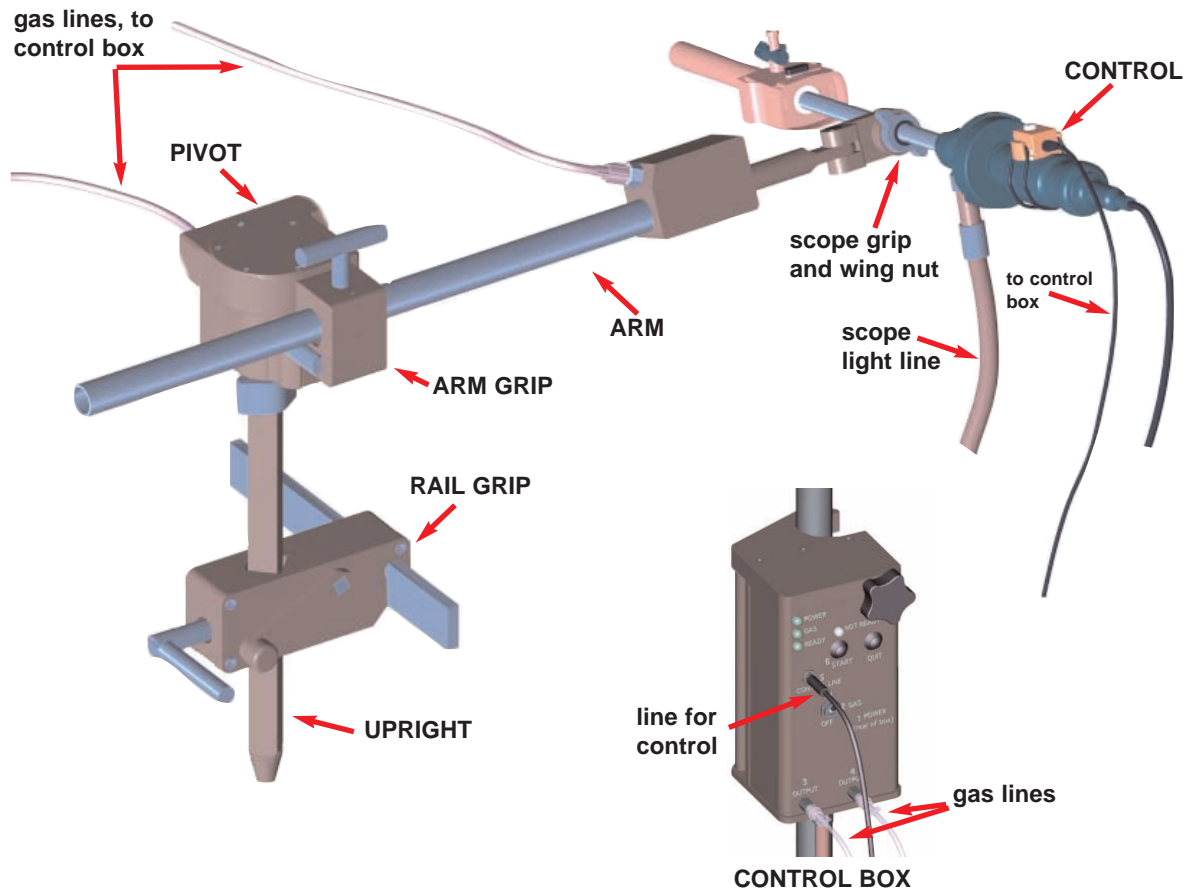

# Parts List for Kronner Low Profile Scope Holder

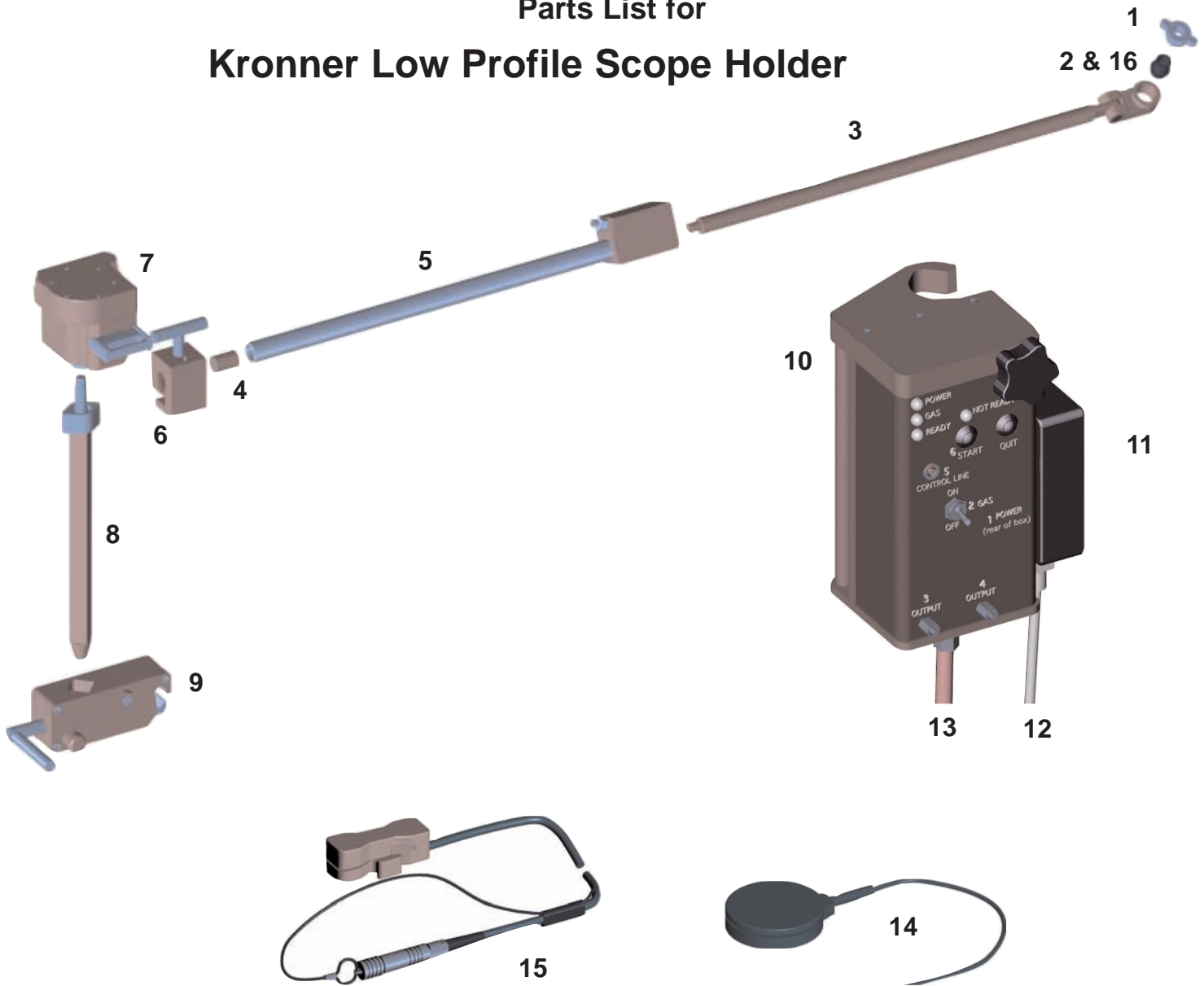

- |                             |                                      |
|-----------------------------|--------------------------------------|
| 1. Kronner 503              | Wing Nut                             |
| 2. Kronner 502              | Scope Grip, collet 10 mm, square end |
| 3. Kronner 500              | Inner Rod for collet scope grip      |
| 4. Kronner 515              | Inner Rod Retainer                   |
| 5. Kronner 400              | Outer Arm                            |
| 6. Kronner 3100             | Arm Grip                             |
| 7. Kronner 3000             | Main Pivot, two axis                 |
| 8. Kronner 3200             | Upright, length, 15 inches           |
| 9. Kronner 100              | Rail Grip                            |
| 10. Kronner 1100            | Control box, pole mounted            |
| 11. Ault Power supply SW172 | Power Supply, 110 volt               |
| 12. Kronner 1107            | 110 volt Power supply cord           |
| 13. Kronner 1130            | Nitrogen Gas Supply Line             |
| 14. Kronner 2600            | Control, Foot Pedal                  |
| 15. Kronner 1000            | Control, camera mounted              |
| 16. Kronner 510             | Scope Grip, 5 mm, square end         |

set wall nitrogen pressure  
to 140-150 PSI