

The KRONNER SIDE-KICK

A Perineal Instrument Holder

for holding the RUMI uterine manipulator
and optional vaginal retractor

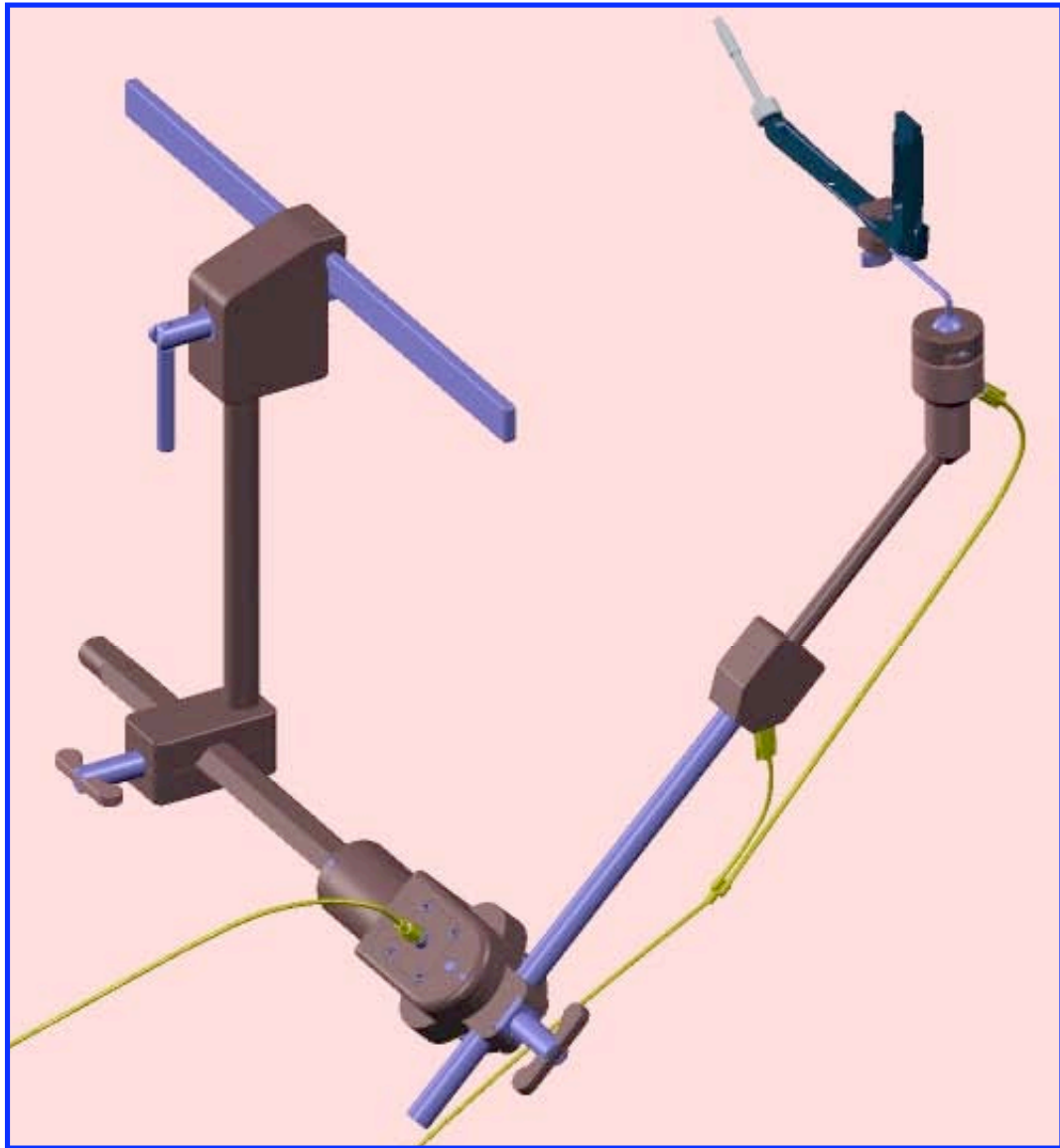

1. Firmly holds the manipulator.
2. Unrestricted manipulator positioning.
3. Foot pedal activation for manipulator re-positioning.
4. Adapters for other manipulators, vaginal retractors and endoscope holders.
5. Instruments and adapters can be changed during the procedure.
6. Reduces manipulator holder fatigue.
7. Especially useful with the DaVinci.

The KRONNER SIDE-KICK A Perineal Instrument Holder

Richard F. Kronner MD FACS

The **Kronner SIDE-KICK** which is a **Perineal Instrument Holder** firmly holds the RUMI and other uterine manipulators during laparoscopic surgery. It also holds retractors during vaginal and other perineal surgery, thereby freeing a person for performing other tasks. The Side-Kick does not interfere with re-positioning the uterus with the inserted manipulator.

The Side-Kick is attached to either side of the operating table rail behind the leg stirrup attachment.

The manipulator is inserted into the patient using standard technique, then the Side-Kick is joined to it.

With proper adapters the Side-Kick may be used with various manipulators, such as the Apple, the RUMI, the Pelosi, the V-Care*, the Kronner Manipjector, other types, and also a perineal retractor. The retractor can be exchanged for the manipulator during surgery.

A gas supply module, which can also be attached to the operating table rail, transfers gas from the wall or a portable tank to the Side-Kick through two flexible lines. When the switch is turned off the Side-Kick joints are decompressed.

Pressing a foot pedal releases all the Side-Kick joints for position changes. When the foot pedal is released the joints lock. The foot pedal is connected to the gas supply module through a single line.

A branched gas line connects the two luers of the Arm assembly to the supply module. A single gas line joins the main pivot to the gas supply module.

Under most circumstances only the arm and adapter is sterilized. It may be steam autoclaved. The disposable gas lines are supplied sterile.

*See V-Care literature for components required.

COMPONENTS

Holder assembly

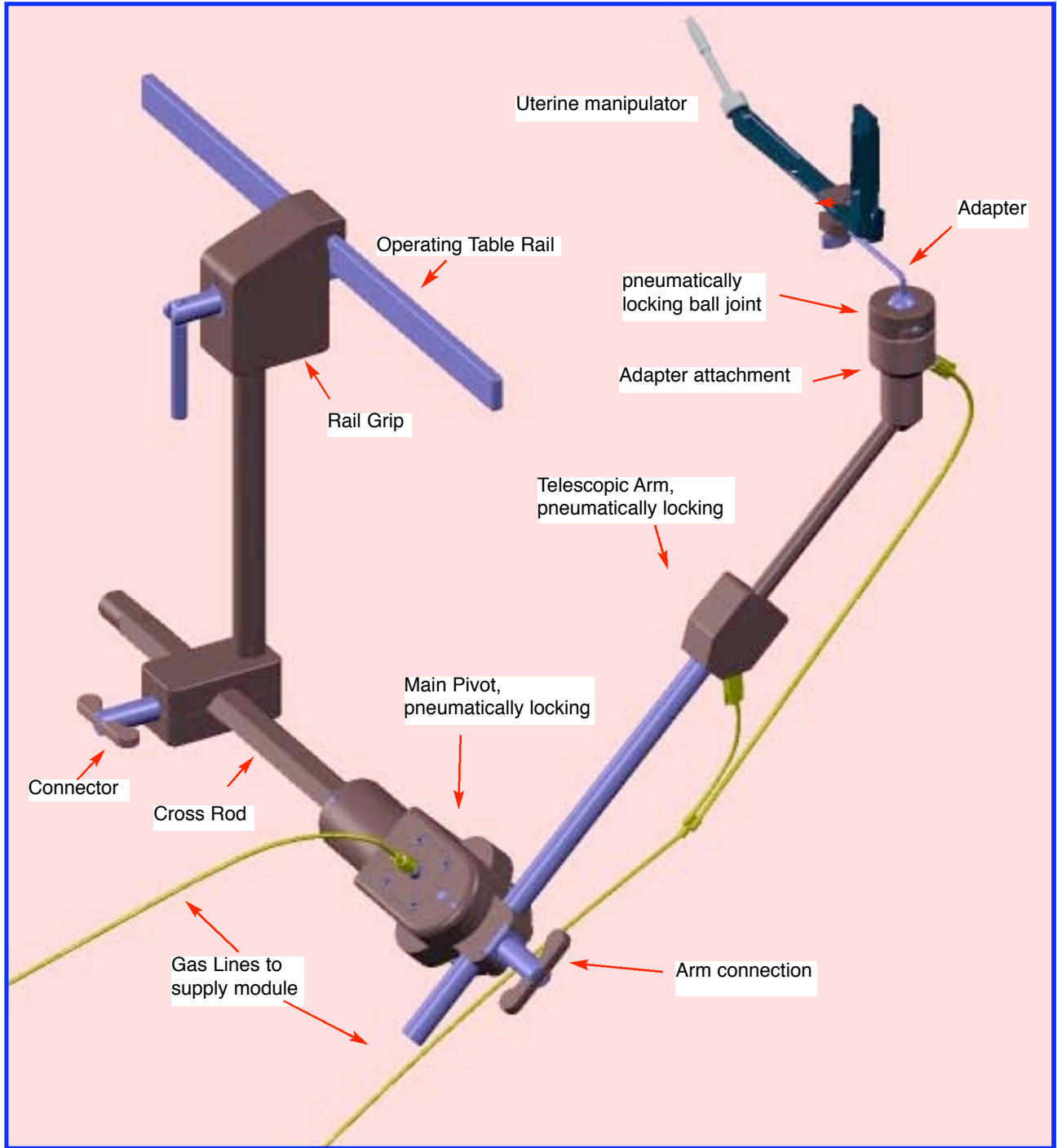

GAS SUPPLY MODULE

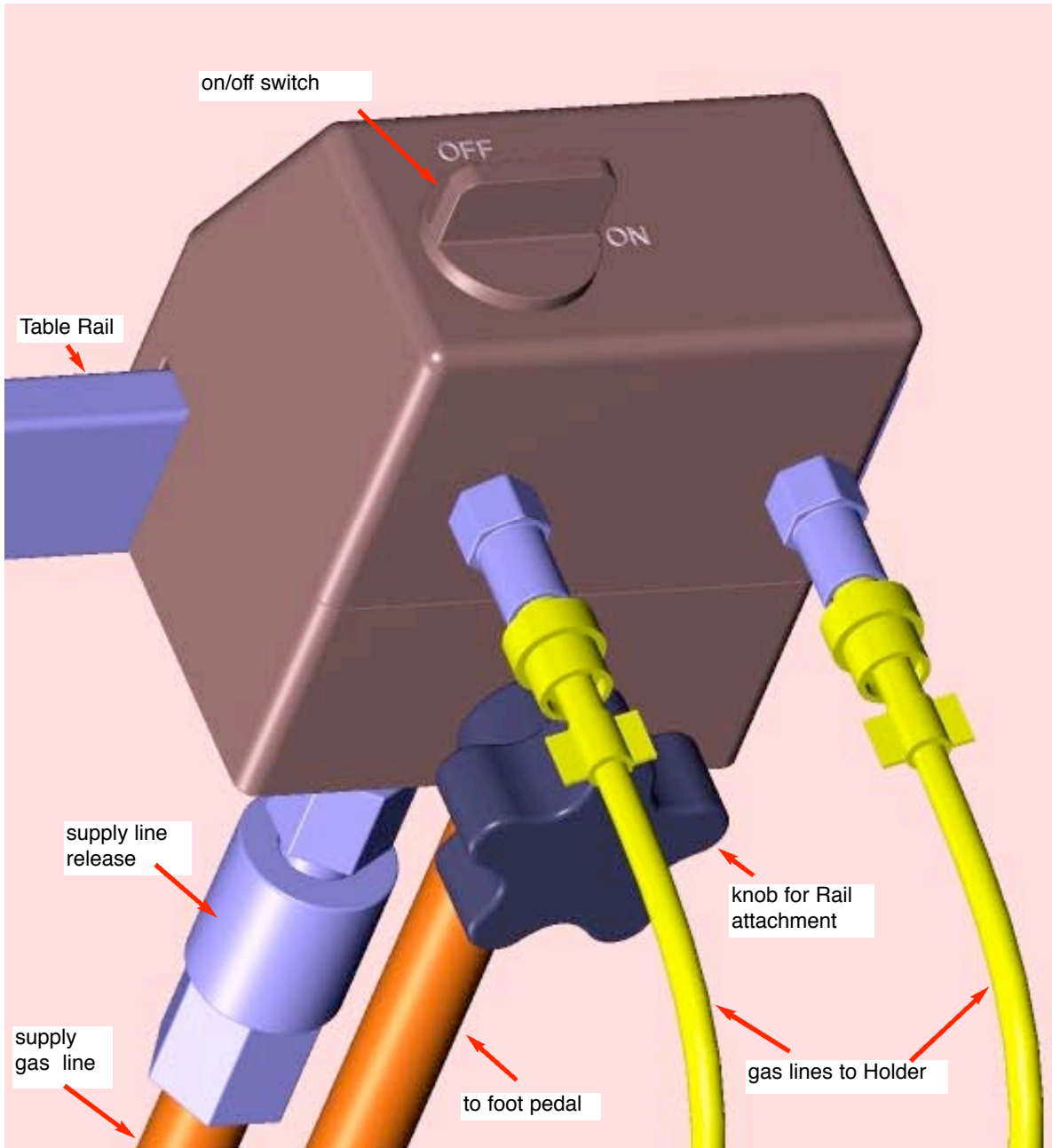

FOOT PEDAL CONTROL

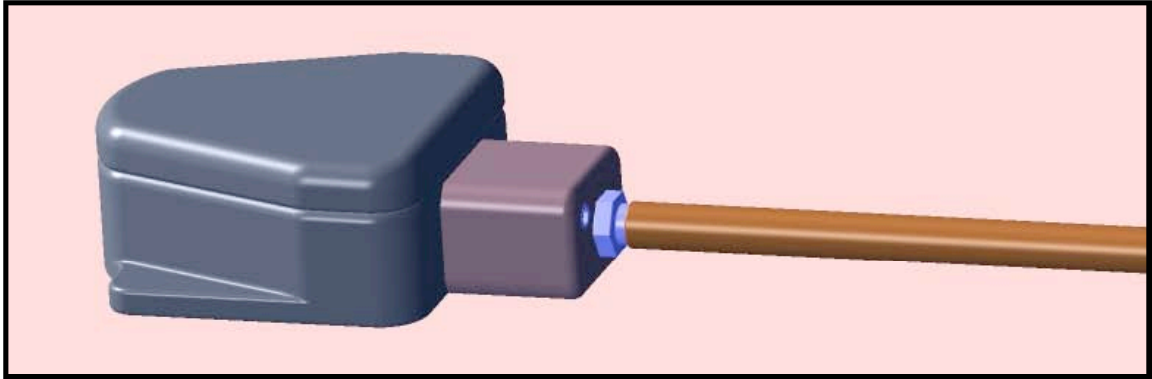

RUMI ADAPTER

RUMI Adapter

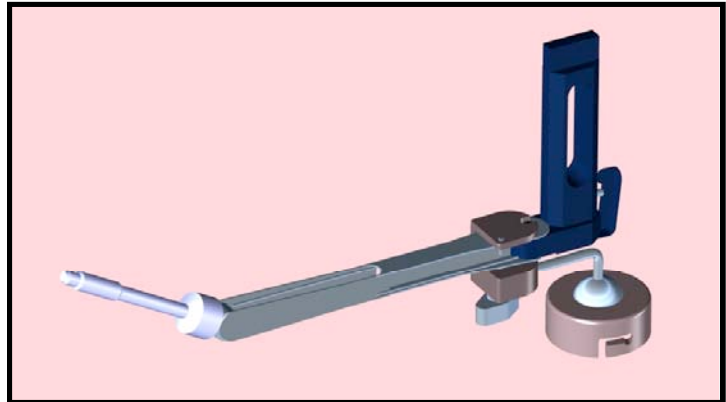
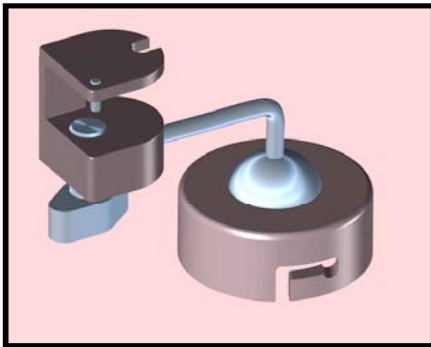

VAGINAL AND PERINEAL RETRACTOR ACCESSORY

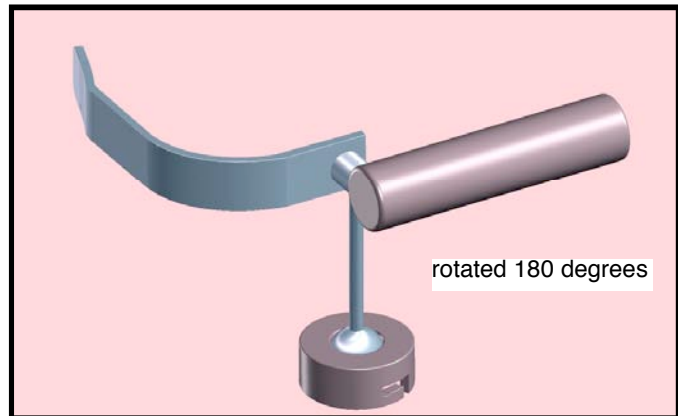
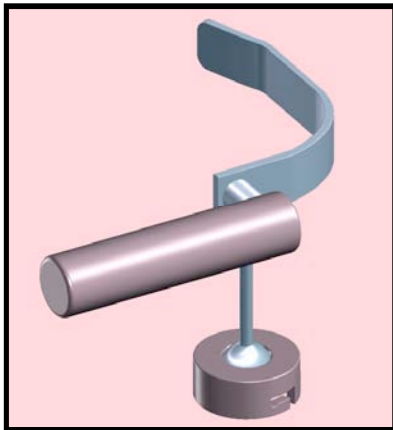

STERILE COMPONENTS

Note: the user may elect not to sterilize some of these components.

Joining the inner rod to the arm.

1. Insert the inner rod into the arm.
2. If resistance is met, gas pressure may not have been released after the last use. Press the luer stem with a metal object such as a straight kelly clamp. Avoid displacing the stem sideways.

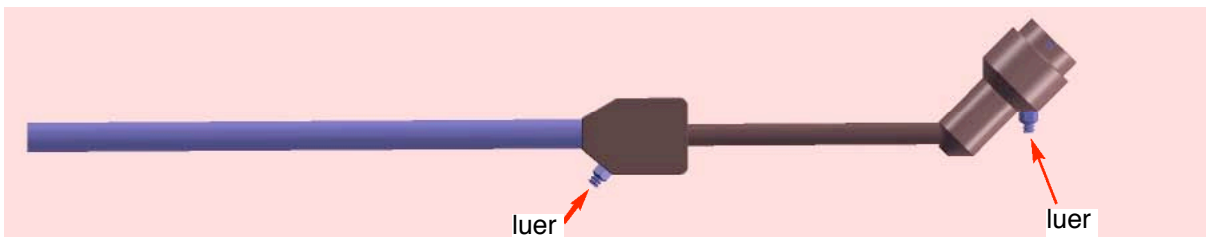

JOINING THE RUMI TO THE ADAPTER

1. Set the attachment screw so the RUMI can be slid into the attachment recess.
2. Slide the RUMI into the attachment recess. This connection is made just in front of the RUMI handle.

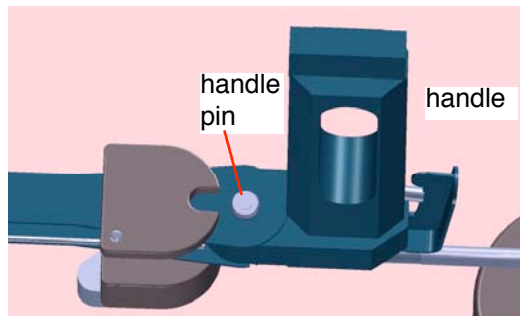
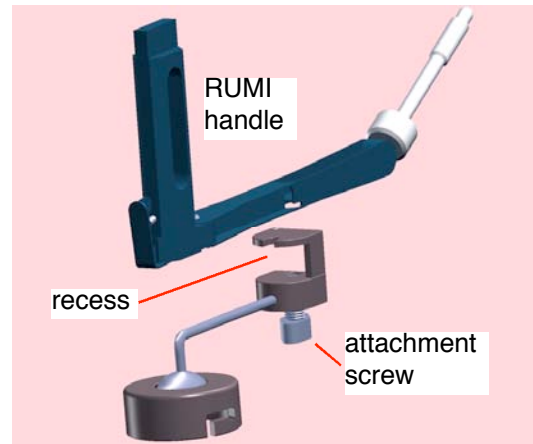

3. Position the RUMI adapter in front of the RUMI handle pin.

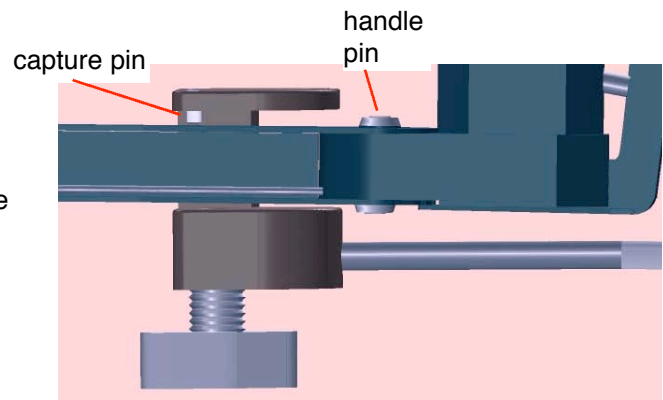

4. Make certain the capture pin is past the RUMI edge.

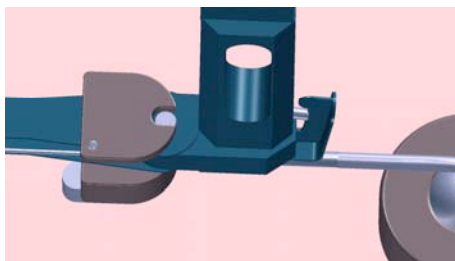

5. Slide the adapter over the RUMI handle pin.

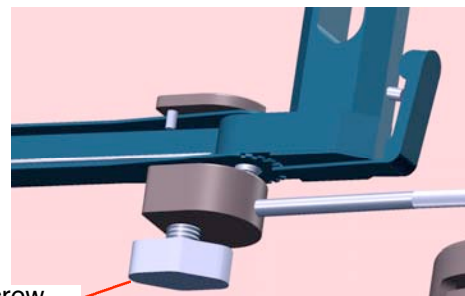

6. Tighten the attachment screw.

NON-STERILE COMPONENTS

Setting up the Gas Supply Module

1. Attach the gas supply module to the operating table rail at a position where the flexible gas lines will reach to the Holder gas line connections. Usually this is just beside the planned position for the Holder rail grip.
2. Turn off the module switch. This will prevent gas from leaking from the luer connections prior to flexible gas line connection.
3. Connect the gas line to the hospital nitrogen* supply.
4. Set the supply to 130-150 PSI.
5. Position the attached foot pedal. (Note that it cannot be disconnected from the supply module.)

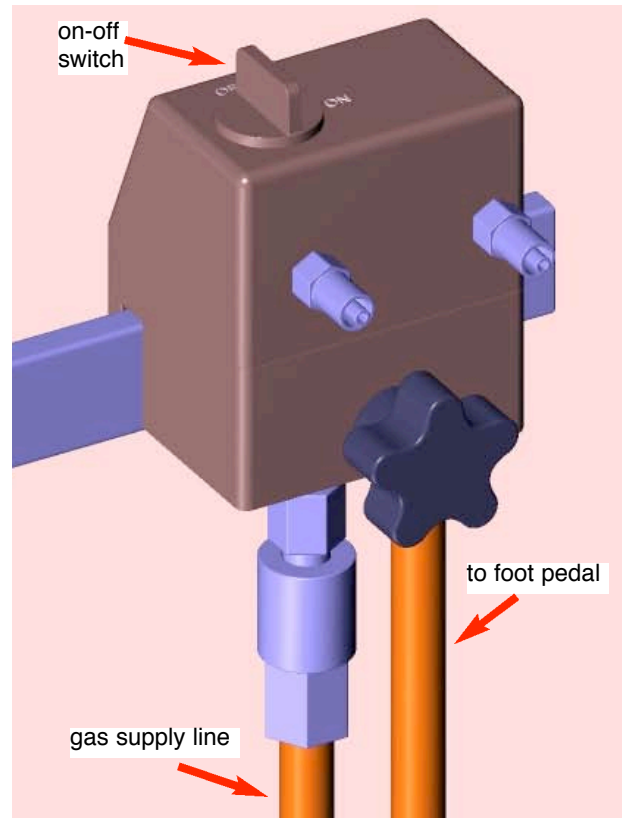

*not nitrous oxide

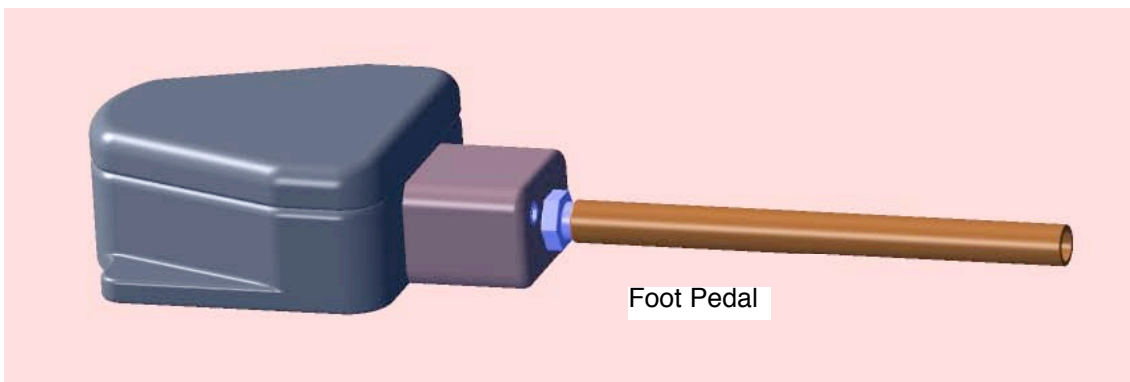

Attaching the rail grip assembly to the operating table rail.

The rail grip assembly can be attached to either rail, it is placed behind the attachment for the leg stirrup.

1. Rotate the rail grip handle counter-clockwise until the bottom of the lower rail grip aligns with the index mark.

This setting will allow the rail grip assembly to be attached by tilting it outward.

In order to attach it without tilting, more counter-clockwise rotations are required.

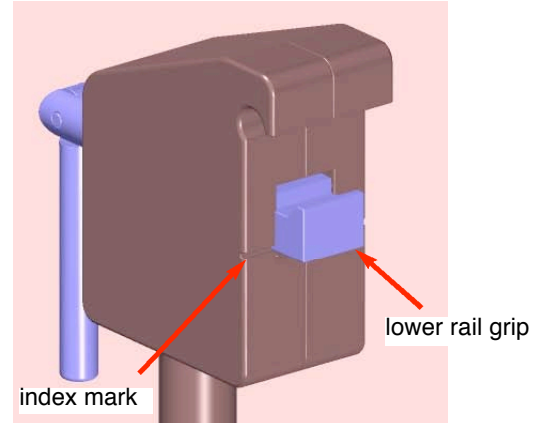

2. Select a position, on the rail, that will place the Holder arm connection directly below the manipulator attachment.*
3. Tilt the assembly outward and attach it to the rail.

Corrections can be made later by repositioning the main pivot assembly.*

The rail grip can be released and slid on the rail to re-position.*

*The design of the Holder allows for variability in these settings.

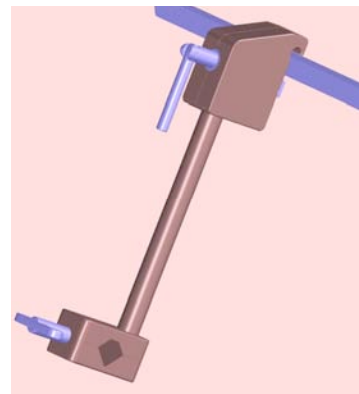

4. Rotate the handle clockwise until it is tight, approximately three full rotations.

Be sure the assembly is hanging straight downward in both planes during this step and the rail grip upper notch is touching the rail on both sides of the rail grip.

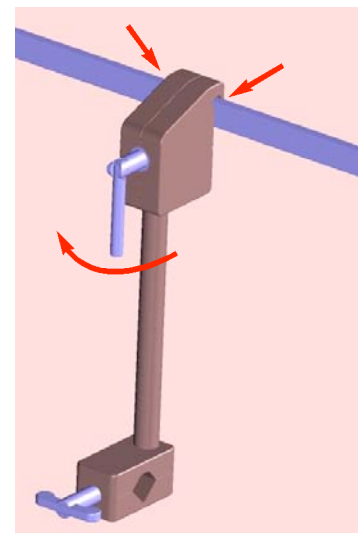

Attaching the main pivot assembly to the connector of the rail grip assembly

1. Rotate the T-handle counter-clockwise to a stop to open the connection joint for the main pivot cross rod.

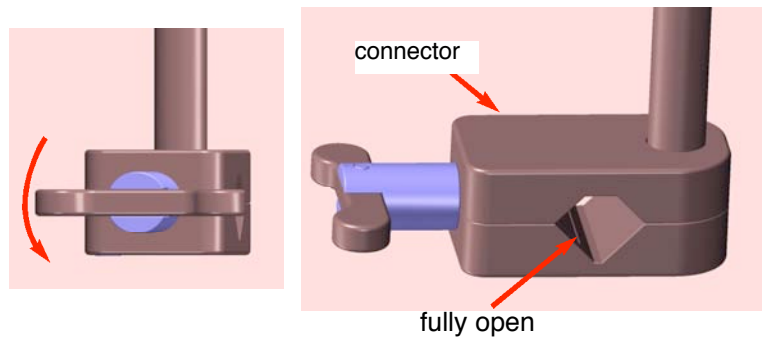

2. Position the main pivot and cross rod so "UP" is positioned upward.

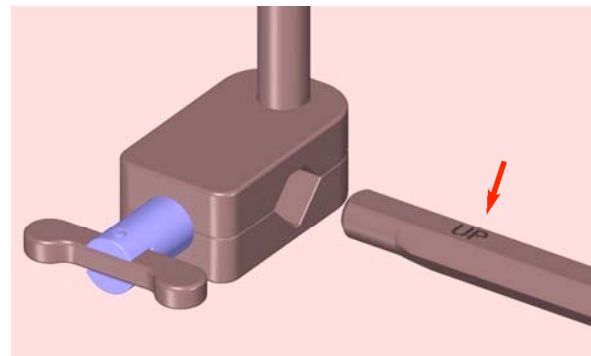

3. Insert the cross rod into the connection joint.

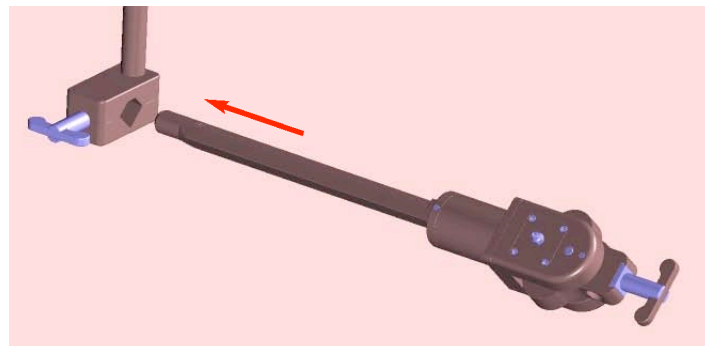

4. Slide the main pivot until the arm connection is located below the planned connection to the manipulator.

5. Firmly tighten the T-handle clockwise.

This setting can be changed later, if needed.

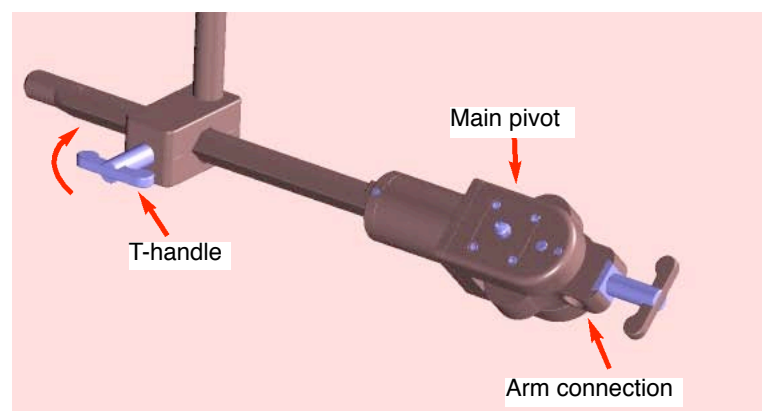

Attaching the arm to the main pivot.

1. Rotate the main pivot handle counter-clockwise to a stop to open the attachment joint.

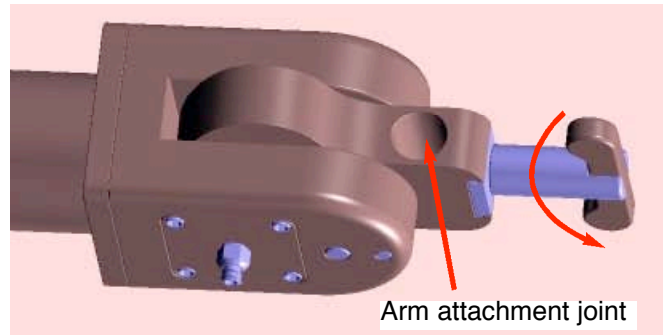

2. Insert the arm assembly into the attachment joint until the telescoping rod will allow for the required manipulator movement.

This setting can be changed later, if necessary.

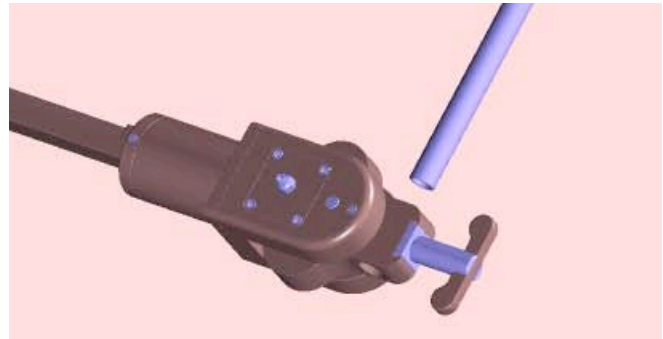

3. Tighten the main pivot handle clockwise.

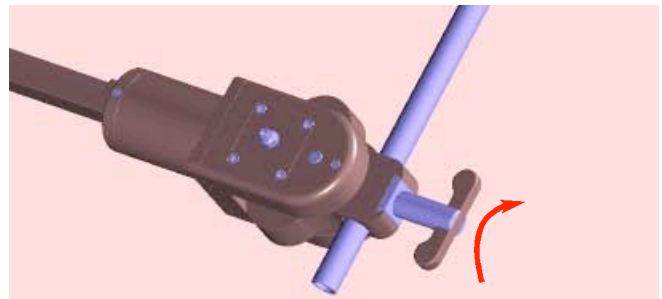

Stops prevent the arm from falling prior to pressurizing the system.

4. Lower the arm sideways to one of the stops or continue to hold it during the next steps.



Attaching the gas lines

1. Connect the single gas line to the main pivot luer.

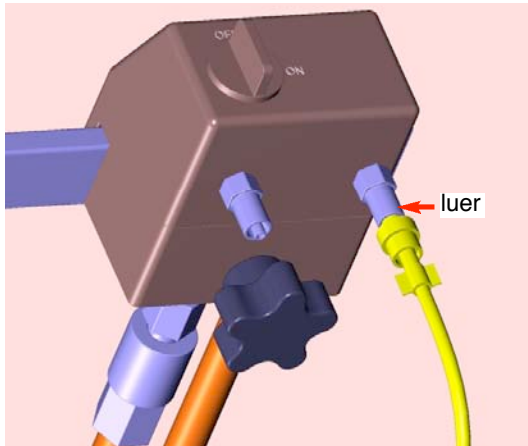
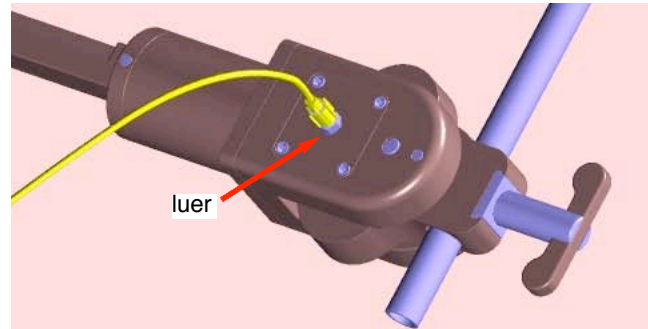

2. Connect the other end of the gas line to one of the gas output luers of the supply module.

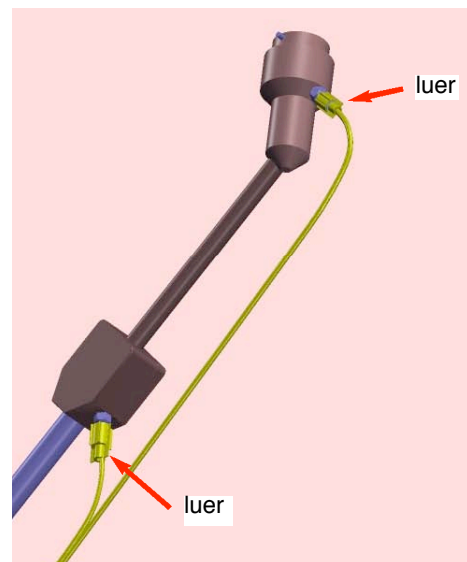

3. Connect the branched line to the two luers of the arm assembly.

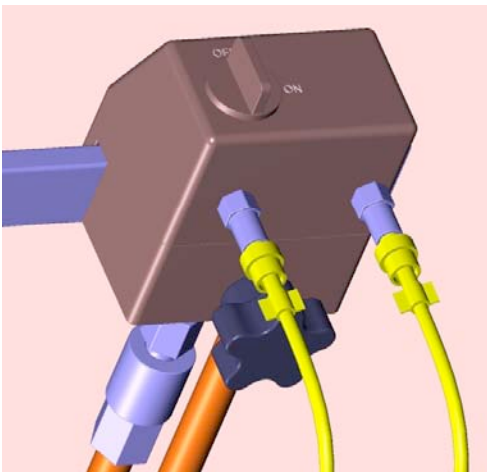

4. Connect the other end to the supply module.

The gas line connections to the arm may be made prior to joining the arm to the main pivot assembly.

The single gas line may be connected to the pivot and the supply module prior to arm attachment.

Attaching the uterine manipulator to the Holder

1. Insert the RUMI into the patient.

2. Connect the adapter to the arm by sliding the two adapter notches over the arm pins and rotating the adapter clockwise. Gas pressure must be off during this step.

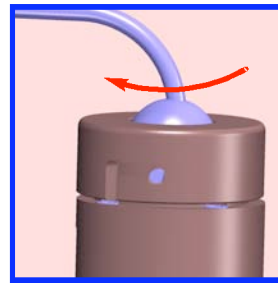
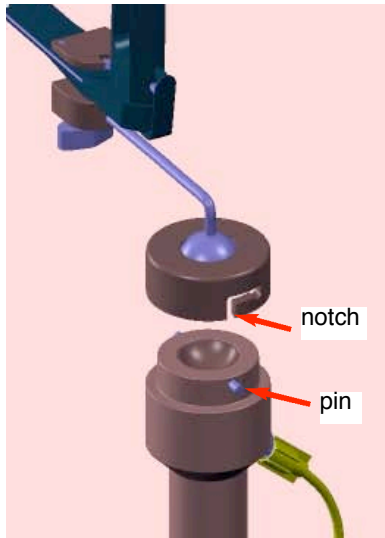

Turning on the gas

1. Turn the supply module switch on.

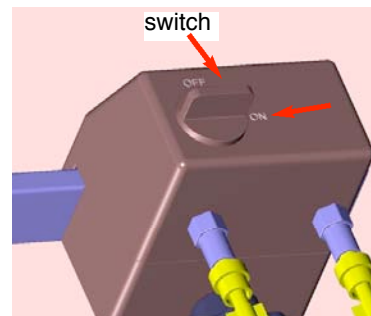

To use the Holder

1. Grasp the manipulator.
2. Press the foot pedal to re-position the attached manipulator.
3. After releasing the foot pedal, allow gas pressure to build prior to releasing the manipulator.

To use the vaginal retractor for LAVH surgery.

1. Turn off the gas at the module or step on the foot pedal.
2. Disconnect the RUMI adapter and replace it with the retractor accessory.
3. Rotate the handle clockwise to position the retractor for retracting the other side of the vagina.

The Kronner Side-Kick A Perineal Instrument Holder

Parts List for the RUMI instrument holder

KSK-5000 The Kronner Side-Kick

Reusable components:

Not autoclavable:

1. 5100-5150-5200 Rail grip and connector assembly
2. 5300 Main pivot assembly
3. 700-5800 Pneumatic foot pedal and Gas supply module
5. K-1120 Gas supply hose, (attaches to hospital gas wall outlet)

Steam autoclavable:

1. 5400 Outer Arm assembly
2. 5500 Inner rod arm with adapter end
3. RA-1 RUMI manipulator adapter
4. VPRA-1 Vaginal and perineal retractor accessory, (optional)

Disposable components, provided sterile,
(one set required for each procedure)

1. HPL1-BL1 Branched gas line set, contains:
 - a. Branched line with two luer fittings on the distal end and one luer fitting on the proximal end.
Length, eight feet.
 - b. Straight gas line, with luer fittings on each end.
Length eight feet.

Kronner Medical

**1443 Upper Cleveland Rapids Road
Roseburg, Oregon 97471**

Phone: (800) 706-3533 or (541) 672-2543

Fax: (541) 672-1074

E-mail: kronner@rosenet.net Website: www.kronner.com