

The Kronner Side-kick RUMI Uterine Manipulator Holder

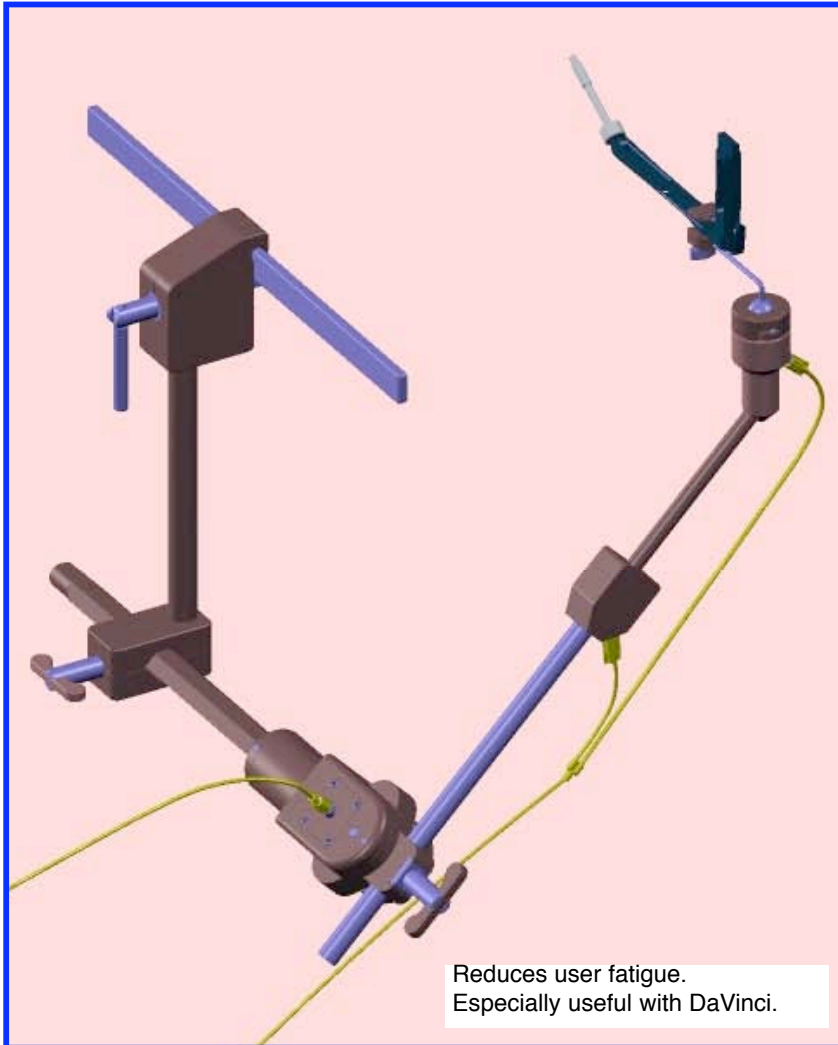

Reduces user fatigue.
Especially useful with DaVinci.

The **Kronner SIDE-KICK**, firmly holds the RUMI uterine manipulator during laparoscopic surgery. Pressing a foot pedal releases all Sidekick joints for re-positioning the uterus.

Side-Kick is attached to either side of the operating table rail behind the leg stirrup attachment. The manipulator is inserted into the patient using standard technique, then Side-Kick is joined to it through the RUMI adapter.

With proper adapters Side-Kick may be used with other manipulators such as V-Care, Apple, Pelosi, the Kronner Manipjector, other types, and also a perineal retractor.

A gas supply module, which can be attached to the operating table rail, transfers gas from the wall or a portable tank to Side-Kick through two disposable lines. The lines are supplied sterile.

Under most circumstances only the arm assembly and adapters are sterilized. They may be steam autoclaved.

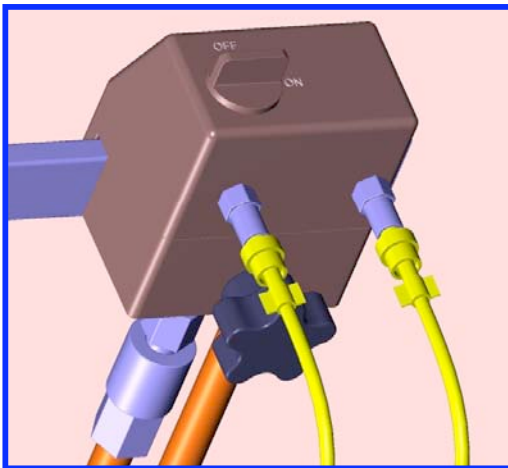

Gas supply module,
connected to wall outlet

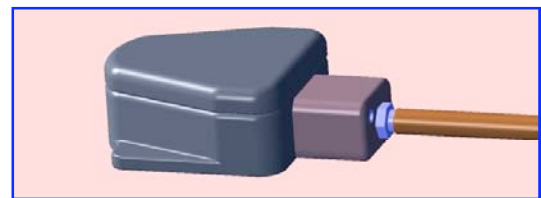

Foot pedal

Kronner Medical

**1443 Upper Cleveland Rapids Road
Roseburg, Oregon 97471**

Phone: (800) 706-3533 or (541) 672-2543

Fax: (541) 672-1074

E-mail: kronner@rosenet.net Website: www.kronner.com